

# SPI-315 C Iris damper

Article no.: 6757



Pictures are only illustrative. They can differ from the visual shape of the selected product variant.

## Description

The SPI is an iris damper for measurement and adjustment of the air flow. The SPI has the following specifications: low sound level, centrally formed air flow and fixed test points for precise measurements. This device can be used for supply as well as for extract air.

## Design

The damper is manufactured from galvanised sheet steel and is fitted with a rubber gasket tested for air-tightness in class C according to EN 1751. It has an adjustment aperture which can open the entire cross-section, so there is no access door for cleaning required. Available in sizes  $\varnothing$  80-800mm.

## Mounting

The SPI adjustment damper must be installed in accordance with the distances required to minimize air flow deviation. Reducing or enlarging the duct to the next duct size does not require any specified distances for minimizing the deviation. The SPI enables taking precise air-flow measurements at all points including points close to T junctions and bends, and points in front of air ducted or terminal devices.

# SPI-315 C Iris damper

Article no.: 6757

## Configuration

Parameter	Value
Size	315

# SPI-315 C Iris damper

Article no.: 6757

## Dimensions

### Dimensions

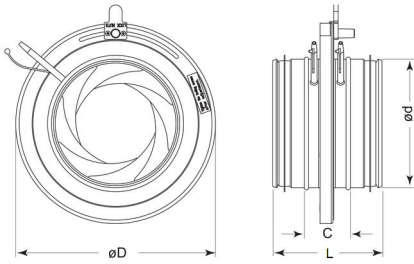

Dimensions	Value (mm)
ød	314
C	90
øD	406
L	165

## Weight

Part	Weight (kg)
SPI-315 C Iris damper	3.70

# SPI-315 C Iris damper

Article no.: 6757

---

## Documents

[DeclarationOfConformity\\_SPI\\_EN \(en-GB\)](#)

[SPI IMO\\_205236\\_A001 \(en-GB\)](#)

# SPI-315 C Iris damper

Article no.: 6757

## Calculation

Working point adjusted to closest valid point in diagram

### Pressure drop & sound power level (A-weighted)

Total sound power level (A-weighted) - Discharged into room

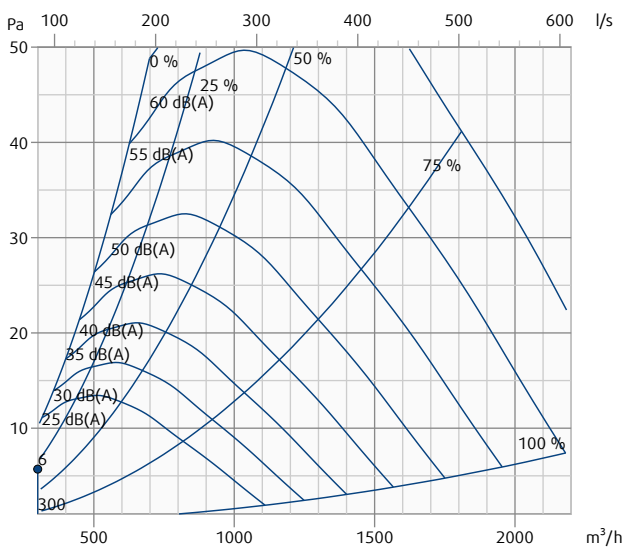

Parameter	Value	
Air flow	300	m <sup>3</sup> /h
Pressure drop	6	Pa
Damper setting	31	%
Damper setting	31	%
Total sound power level - Discharged into room	26	dB
Total sound power level (A-weighted) - Discharged into room	<20	dB(A)

Total sound power level - Discharged into room									
	Hz	63	125	250	500	1k	2k	4k	8k
L <sub>w</sub>	dB	26	8	6	<5	<5	<5	<5	8
L <sub>WA</sub>	dB(A)	<5	<5	<5	<5	<5	<5	<5	6

# SPI-315 C Iris damper

Article no.: 6757

## Gallery



Pictures are only illustrative. They can differ from the visual shape of the selected product variant.

# SPI-315 C Iris damper

Article no.: 6757

## Associated products

TUNE-S



Control Damper

SPM



Iris Damper

# SPI-315 C Iris damper

Article no.: 6757

---

## Accessories